

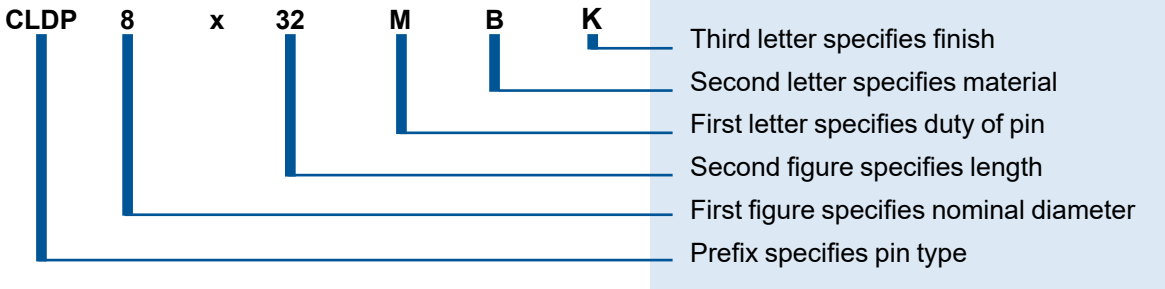

PIN DUTIES	MATERIAL	FINISHES
M Standard	B High Carbon Steel	K Plain, Oiled
H Heavy	C Chrome Stainless Steel	T Electroplated Zinc
L Light	D Nickel Stainless Steel	
	W Alloy Steel	

Identification Code

Coiled Pin 8mm diameter x 32mm length standard duty/carbon steel/plain finish



How to Measure the Diameter of a Coiled Spring Pin

The outside diameter of a Coiled Pin is to be measured with a micrometer from the seam (0° point) through the 90° point. Diameter is to be measured a minimum of one pin diameter in length from the end of the pin.

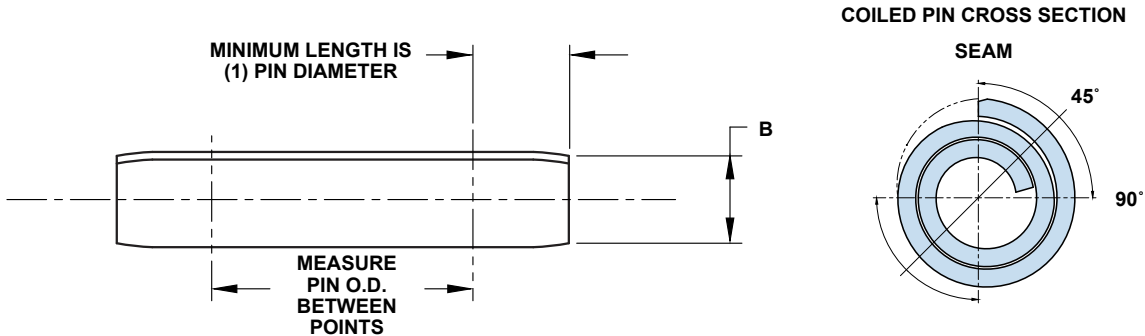

NOTES
<ul style="list-style-type: none"> • Standard specifications apply except where otherwise specified. • All dimensions apply prior to plating. • Electroplated zinc is not available for pins greater than or equal to 8mm and .312" nominal diameter. • The standard finish for stainless steel pins is plain. Passivated pins are available at an additional cost. • Special sizes, duties, materials and finishes, including oil-free pins, are available upon request.

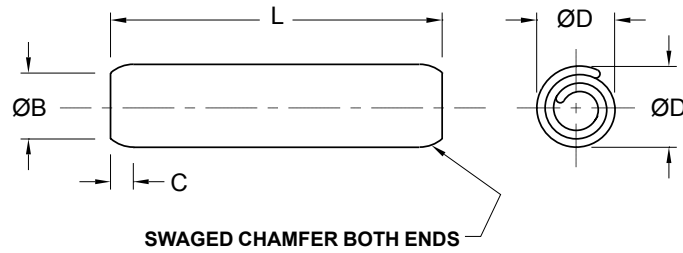

NOMINAL DIAMETER		0.8	1	1.2	1.5	2	2.5	3	3.5	4	5	6	8	10	12	16	20
DIAMETER ØD	MAX.	0.91	1.15	1.35	1.73	2.25	2.78	3.30	3.84	4.40	5.50	6.50	8.63	10.80	12.85	17.00	21.10
	MIN.	0.85	1.05	1.25	1.62	2.13	2.65	3.15	3.67	4.20	5.25	6.25	8.30	10.35	12.40	16.45	20.40
CHAMFER	B DIA. MAX.	0.75	0.95	1.15	1.40	1.90	2.40	2.90	3.40	3.90	4.85	5.85	7.80	9.75	11.70	15.60	19.60
	C LENGTH REF.	0.30	0.30	0.40	0.50	0.70	0.70	0.90	1.00	1.10	1.30	1.50	2.00	2.50	3.00	4.00	4.50
RECOMMENDED HOLE SIZE	MAX.	0.84	1.04	1.24	1.60	2.10	2.60	3.10	3.62	4.12	5.12	6.15	8.15	10.15	12.18	16.18	20.21
	MIN.	0.80	1.00	1.20	1.50	2.00	2.50	3.00	3.50	4.00	5.00	6.00	8.00	10.00	12.00	16.00	20.00

Note: All dimensions apply prior to plating.

MINIMUM DOUBLE SHEAR STRENGTH kN

NOMINAL DIAMETER		0.8	1	1.2	1.5	2	2.5	3	3.5	4	5	6	8	10	12	16	20
CARBON ALLOY STEEL		0.40	0.60	0.90	1.45	2.50	3.90	5.50	7.50	9.60	15	22	39	62	89	155	250
CHROME STAINLESS																	
NICKEL STAINLESS		0.30	0.45	0.65	1.05	1.90	2.90	4.20	5.70	7.60	11.50	16.80	30	48	67	—	—

Note: Shear tests performed in accordance ASME B18.8.3M and ISO 8749.

STANDARD LENGTHS

NOMINAL DIAMETER		0.8	1	1.2	1.5	2	2.5	3	3.5	4	5	6	8	10	12	16	20
4																	
5		*	*	*	*												
6		*	*	*	*	*											
8		*	*	*	*	*	*										
10		*	*	*	*	*	*	*									
12		*	*	*	*	*	*	*	*								
14					*	*	*	*	*	*							
16					*	*	*	*	*	*	*						
18					*	*	*	*	*	*	*	*					
20					*	*	*	*	*	*	*	*	*				
22					*	*	*	*	*	*	*	*	*	*			
24					*	*	*	*	*	*	*	*	*	*	*		
26					*	*	*	*	*	*	*	*	*	*	*	*	
28					*	*	*	*	*	*	*	*	*	*	*	*	*
30					*	*	*	*	*	*	*	*	*	*	*	*	*
32					*	*	*	*	*	*	*	*	*	*	*	*	*
35					*	*	*	*	*	*	*	*	*	*	*	*	*
40					*	*	*	*	*	*	*	*	*	*	*	*	*
45					*	*	*	*	*	*	*	*	*	*	*	*	*
50					*	*	*	*	*	*	*	*	*	*	*	*	*
55					*	*	*	*	*	*	*	*	*	*	*	*	*
60					*	*	*	*	*	*	*	*	*	*	*	*	*
65					*	*	*	*	*	*	*	*	*	*	*	*	*
70					*	*	*	*	*	*	*	*	*	*	*	*	*
75					*	*	*	*	*	*	*	*	*	*	*	*	*
80					*	*	*	*	*	*	*	*	*	*	*	*	*
85					*	*	*	*	*	*	*	*	*	*	*	*	*
90					*	*	*	*	*	*	*	*	*	*	*	*	*
95					*	*	*	*	*	*	*	*	*	*	*	*	*
100					*	*	*	*	*	*	*	*	*	*	*	*	*

Interchangeable mm and Inch Pins

mm Diameter	Inch Diameter
0.8	.031 1/32
1.0	.039
1.2	.047 3/64
2.0	.078 5/64
4.0	.156 5/32
8.0	.312 5/16
16.0	.625 5/8

Nominal Pin Length	Length Tolerance	
Nominal Pin Size	ø0.8 - 10	ø12 - 20
L ≤ 10	±0.25	N/A
10 < L ≤ 50	±0.5	±0.5
50 < L	±0.75	±0.75

Pin Straightness Tolerance ¹			Gage Length ±0.15
Gage Hole Diameter			
Specified Maximum Pin Diameter Plus:			
Nominal Pin Length	Min.	Max.	
L ≤ 24	0.18	0.2	25
24 < L ≤ 50	0.3	0.34	50
50 < L	0.42	0.48	75

 Only available in stainless steel
 Available in high carbon and stainless steels
 Only available in alloy steel

* Generally stocked size

¹ Pin must fall through the gage by its own weight.

Special sizes, duties, materials and finishes, including oil-free pins, are available upon request.



HEAVY DUTY COILED PINS – METRIC ISO 8748 • ASME B18.8.3M

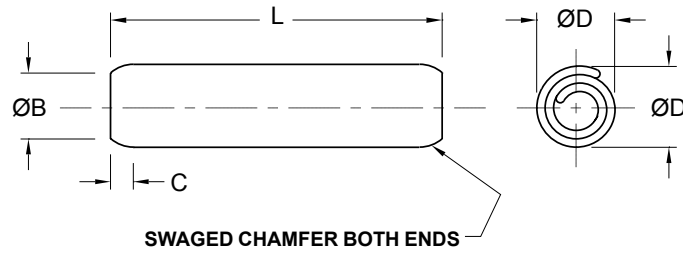

NOMINAL DIAMETER		1.5	2	2.5	3	3.5	4	5	6	8	10	12	16	20
DIAMETER ØD	MAX.	1.71	2.21	2.73	3.25	3.79	4.30	5.35	6.40	8.55	10.65	12.75	16.90	21.00
	MIN.	1.61	2.11	2.62	3.12	3.64	4.15	5.15	6.18	8.25	10.30	12.35	16.40	20.40
CHAMFER	B DIA. MAX.	1.40	1.90	2.40	2.90	3.40	3.90	4.85	5.85	7.80	9.75	11.70	15.60	19.60
	C LENGTH REF.	0.50	0.70	0.70	0.90	1.00	1.10	1.30	1.50	2.00	2.50	3.00	4.00	4.50
RECOMMENDED HOLE SIZE	MAX.	1.60	2.10	2.60	3.10	3.62	4.12	5.12	6.15	8.15	10.15	12.18	16.18	20.21
	MIN.	1.50	2.00	2.50	3.00	3.50	4.00	5.00	6.00	8.00	10.00	12.00	16.00	20.00

Note: All dimensions apply prior to plating.

MINIMUM DOUBLE SHEAR STRENGTH kN

NOMINAL DIAMETER		1.5	2	2.5	3	3.5	4	5	6	8	10	12	16	20
CARBON ALLOY STEEL		1.90	3.50	5.50	7.60	10	13.50	20	30	53	84	120	210	340
CHROME STAINLESS														
NICKEL STAINLESS		1.45	2.50	3.80	5.70	7.60	10	15.50	23	41	64	91	—	—

Note: Shear tests performed in accordance ASME B18.8.3M and ISO 8749.

STANDARD LENGTHS

NOMINAL DIAMETER		1.5	2	2.5	3	3.5	4	5	6	8	10	12	16	20
LENGTHS	4	*												
	5	*	*											
	6	*	*	*										
	8	*	*	*	*									
	10	*	*	*	*		*							
	12	*	*	*	*		*							
	14	*	*	*	*		*	*						
	16	*	*	*	*		*	*	*					
	18		*	*	*		*	*	*	*				
	20		*	*	*		*	*	*	*	*			
	22		*	*	*		*	*	*	*	*	*		
	24		*	*	*		*	*	*	*	*	*		
	26			*	*		*	*	*	*	*	*		
	28				*		*	*	*	*	*	*	*	
	30				*		*	*	*	*	*	*	*	
	32							*	*	*	*	*	*	
	35							*	*	*	*	*	*	*
	40							*	*	*	*	*	*	*
	45							*	*	*	*	*	*	*
	50							*	*	*	*	*	*	*
55									*	*	*	*	*	
60									*	*	*	*	*	
65									*	*	*	*	*	
70									*	*	*	*	*	
75									*	*	*	*	*	
80									*	*	*	*	*	
85										*	*	*	*	
90										*	*	*	*	
95										*	*	*	*	
100										*	*	*	*	

Nominal Pin Length		Length Tolerance	
Nominal Pin Size	ø1.5 - 10	ø12-20	
L ≤ 10	±0.25	N/A	
10 < L ≤ 50	±0.5	±0.5	
50 < L	±0.75	±0.75	

Pin Straightness Tolerance ¹		
Gage Hole Diameter		
<i>Specified Maximum Pin Diameter Plus:</i>		
Nominal Pin Length	Min.	Max.
L ≤ 24	0.18	0.2
24 < L ≤ 50	0.3	0.34
50 < L	0.42	0.48

Gage Length	
Nominal Pin Length	±0.15
L ≤ 24	25
24 < L ≤ 50	50
50 < L	75

Interchangeable mm and Inch Pins		
mm Diameter	Inch Diameter	
2.0	.078	5/64
4.0	.156	5/32
8.0	.312	5/16
16.0	.625	5/8

Available in high carbon and stainless steels Only available in alloy steel

* Generally stocked size

¹ Pin must fall through the gage by its own weight.

Special sizes, duties, materials and finishes, including oil-free pins, are available upon request.

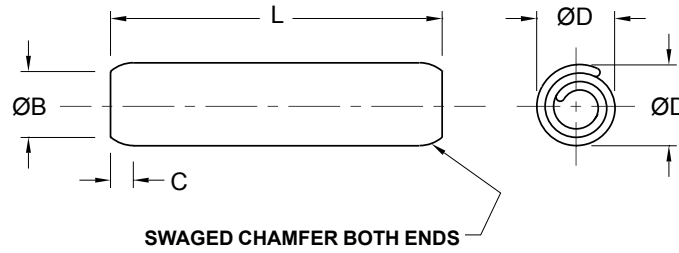

NOMINAL DIAMETER		1.5	2	2.5	3	3.5	4	5	6	8
DIAMETER ØD	MAX.	1.75	2.28	2.82	3.35	3.87	4.45	5.50	6.55	8.65
	MIN.	1.62	2.13	2.65	3.15	3.67	4.20	5.20	6.25	8.30
CHAMFER	B DIA. MAX.	1.40	1.90	2.40	2.90	3.40	3.90	4.85	5.85	7.80
	C LENGTH REF.	0.50	0.70	0.70	0.90	1.00	1.10	1.30	1.50	2.00
RECOMMENDED HOLE SIZE	MAX.	1.60	2.10	2.60	3.10	3.62	4.12	5.12	6.15	8.15
	MIN.	1.50	2.00	2.50	3.00	3.50	4.00	5.00	6.00	8.00

Note: All dimensions apply prior to plating.

MINIMUM DOUBLE SHEAR STRENGTH kN

NOMINAL DIAMETER		1.5	2	2.5	3	3.5	4	5	6	8
CARBON										
ALLOY STEEL		0.80	1.50	2.30	3.30	4.50	5.70	9	13	23
CHROME STAINLESS										
NICKEL STAINLESS		0.65	1.10	1.80	2.50	3.40	4.40	7	10	18

Note: Shear tests performed in accordance ASME B18.8.3M and ISO 8749.

STANDARD LENGTHS

NOMINAL DIAMETER		1.5	2	2.5	3	3.5	4	5	6	8
LENGTHS	6									
	8									
	10									
	12									
	14									
	16									
	18									
	20									
	22									
	24									
	26									
	28									
	30									
	32									
	35									
	40									
	45									
	50									
	55									
	60									
65										
70										
75										
80										
85										
90										
95										

Interchangeable mm and Inch Pins		
mm Diameter	Inch Diameter	
2.0	.078	5/64
4.0	.156	5/32
8.0	.312	5/16

Nominal Pin Length	Length Tolerance		
Nominal Pin Size	ø1.5 - 8		
L ≤ 10	±0.25		
10 < L ≤ 50	±0.5		
50 < L	±0.75		

Pin Straightness Tolerance ¹			
Gage Hole Diameter			
Specified Maximum Pin Diameter Plus:			
Nominal Pin Length	Min.	Max.	Gage Length
L ≤ 24	0.18	0.2	25
24 < L ≤ 50	0.3	0.34	50
50 < L	0.42	0.48	75

Only available in stainless steel
 Available in high carbon and stainless steels

¹ Pin must fall through the gage by its own weight.



STANDARD DUTY COILED PINS – INCH ASME B18.8.2

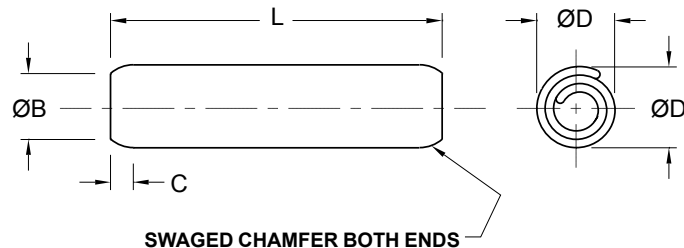

NOMINAL DIAMETER	.031	.039	.047	.052	.062	.078	.094	.109	.125	.156	.187	.219	.250	.312	.375	.437	.500	.625	.750	
	1/32		3/64		1/16	5/64	3/32	7/64	1/8	5/32	3/16	7/32	1/4	5/16	3/8	7/16	1/2	5/8	3/4	
DIAMETER ØD	MAX.	.035	.044	.052	.057	.072	.105	.120	.138	.171	.205	.238	.271	.337	.403	.469	.535	.661	.787	
	MIN.	.033	.041	.049	.054	.067	.083	.099	.114	.131	.163	.196	.228	.260	.324	.388	.452	.516	.642	.768
CHAMFER	B DIA. MAX.	.029	.037	.045	.050	.059	.075	.091	.106	.121	.152	.182	.214	.243	.304	.366	.427	.488	.613	.738
	C LENGTH REF.	.024	.024	.024	.024	.028	.032	.038	.038	.044	.048	.055	.065	.065	.080	.095	.095	.110	.125	.150
RECOMMENDED HOLE SIZE	MAX.	.032	.040	.048	.053	.065	.081	.097	.112	.129	.160	.192	.224	.256	.319	.383	.446	.510	.635	.760
	MIN.	.031	.039	.047	.052	.062	.078	.094	.109	.125	.156	.187	.219	.250	.312	.375	.437	.500	.625	.750

Note: All dimensions apply prior to plating.

MINIMUM DOUBLE SHEAR STRENGTH LBS.

NOMINAL DIAMETER	.031	.039	.047	.052	.062	.078	.094	.109	.125	.156	.187	.219	.250	.312	.375	.437	.500	.625	.750
CARBON ALLOY STEEL	90	135	190	250	330	550	775	1,050	1,400	2,200	3,150	4,200	5,500	8,700	12,600	17,000	22,500	35,000	50,000
CHROME STAINLESS																			
NICKEL STAINLESS	65	100	145	190	265	425	600	825	1,100	1,700	2,400	3,300	4,300	6,700	9,600	13,300	17,500	—	—

Note: Shear tests performed in accordance with ASME B18.8.2.

STANDARD LENGTHS

NOMINAL DIAMETER	.031	.039	.047	.052	.062	.078	.094	.109	.125	.156	.187	.219	.250	.312	.375	.437	.500	.625	.750
.125 1/8	*		*																
.187 3/16	*		*		*														
.250 1/4	*		*		*	*													
.312 5/16	*		*		*	*	*												
.375 3/8	*		*		*	*	*		*										
.437 7/16	*		*		*	*	*		*	*									
.500 1/2	*		*		*	*	*		*	*	*								
.562 9/16					*	*	*		*	*	*								
.625 5/8					*	*	*		*	*	*								
.687 11/16																			
.750 3/4							*	*	*	*	*		*						
.812 13/16																			
.875 7/8								*	*	*	*		*						
.937 15/16																			
1.000 1								*	*	*	*		*	*					
1.125 1-1/8																			
1.250 1-1/4									*	*	*		*	*	*				
1.375 1-3/8																			
1.500 1-1/2										*	*		*	*	*		*		
1.625 1-5/8																			
1.750 1-3/4										*	*		*	*	*		*		
1.875 1-7/8																			
2.000 2										*	*		*	*	*		*	*	*
2.250 2-1/4													*	*	*		*	*	*
2.500 2-1/2													*	*	*		*	*	*
2.750 2-3/4													*	*	*		*	*	*
3.000 3													*	*	*		*	*	*
3.250 3-1/4														*	*		*	*	*
3.500 3-1/2														*	*		*	*	*
3.750 3-3/4															*		*	*	*
4.000 4															*		*	*	*

Interchangeable Inch and mm Pins

Inch Diameter	mm Diameter
.031 1/32	0.8
.039	1.0
.047 3/64	1.2
.078 5/64	2.0
.156 5/32	4.0
.312 5/16	8.0
.625 5/8	16.0

Nominal Pin Length	Length Tolerance
Nominal Pin Size	ø1/32 - 3/8 ø1/2 - 3/4
L ≤ 2.000	± .010 ± .025
2.000 < L ≤ 3.000	± .015 ± .025
3.000 < L	± .025 ± .025

Nominal Pin Length	Pin Straightness Tolerance ¹	Gage Length ±0.005
L ≤ 1.000	.007	1.000
1.000 < L ≤ 2.000	.010	2.000
2.000 < L	.013	3.000

 Only available in stainless steel
 Available in high carbon and stainless steels
 Only available in alloy steel

* Generally stocked size

¹ Pin must fall through a hole gauge in length equal to the next one-inch increment over the pin length with a hole equal to the maximum specified pin diameter plus the straightness tolerance by its own weight.

Special sizes, duties, materials and finishes, including oil-free pins, are available upon request.

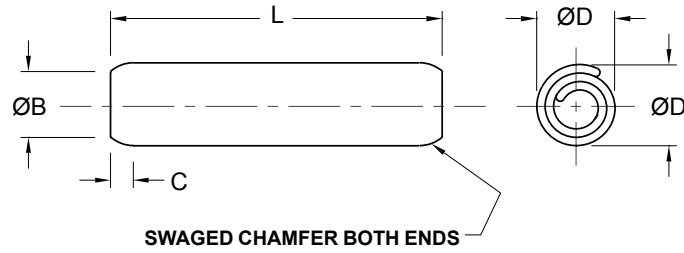

NOMINAL DIAMETER		.062	.078	.094	.109	.125	.156	.187	.219	.250	.312	.375	.437	.500	.625	.750
		1/16	5/64	3/32	7/64	1/8	5/32	3/16	7/32	1/4	5/16	3/8	7/16	1/2	5/8	3/4
DIAMETER ØD	MAX.	.070	.086	.103	.118	.136	.168	.202	.235	.268	.334	.400	.466	.532	.658	.784
	MIN.	.066	.082	.098	.113	.130	.161	.194	.226	.258	.322	.386	.450	.514	.640	.766
CHAMFER	B DIA. MAX.	.059	.075	.091	.106	.121	.152	.182	.214	.243	.304	.366	.427	.488	.613	.738
	C LENGTH REF.	.028	.032	.038	.038	.044	.048	.055	.065	.065	.080	.095	.095	.110	.125	.150
RECOMMENDED HOLE SIZE	MAX.	.065	.081	.097	.112	.129	.160	.192	.224	.256	.319	.383	.446	.510	.635	.760
	MIN.	.062	.078	.094	.109	.125	.156	.187	.219	.250	.312	.375	.437	.500	.625	.750

Note: All dimensions apply prior to plating.

MINIMUM DOUBLE SHEAR STRENGTH LBS.

NOMINAL DIAMETER		.062	.078	.094	.109	.125	.156	.187	.219	.250	.312	.375	.437	.500	.625	.750
		1/16	5/64	3/32	7/64	1/8	5/32	3/16	7/32	1/4	5/16	3/8	7/16	1/2	5/8	3/4
CARBON CHROME STAINLESS		475	800	1,150	1,500	2,000	3,100	4,500	5,900	7,800	12,000	18,000	23,500	32,000	48,000	70,000
NICKEL STAINLESS		360	575	825	1,150	1,700	2,400	3,500	4,600	6,200	9,300	14,000	18,000	25,000	—	—

Note: Shear tests performed in accordance with ASME B18.8.2.

STANDARD LENGTHS

NOMINAL DIAMETER		.062	.078	.094	.109	.125	.156	.187	.219	.250	.312	.375	.437	.500	.625	.750
		1/16	5/64	3/32	7/64	1/8	5/32	3/16	7/32	1/4	5/16	3/8	7/16	1/2	5/8	3/4
LENGTH	.187 3/16	*	*													
	.250 1/4	*	*	*												
	.312 5/16	*	*	*		*										
	.375 3/8	*	*	*		*										
	.437 7/16	*	*	*		*	*									
	.500 1/2	*	*	*		*	*	*								
	.562 9/16	*	*	*		*	*	*	*							
	.625 5/8	*	*	*		*	*	*	*	*						
	.687 11/16										*					
	.750 3/4		*	*		*	*	*	*	*	*					
	.812 13/16															
	.875 7/8			*		*	*	*	*	*	*					
	.937 15/16					*	*	*	*	*	*					
	1.000 1			*		*	*	*	*	*	*	*				
	1.125 1-1/8					*	*	*	*	*	*	*				
	1.250 1-1/4					*	*	*	*	*	*	*	*			
	1.375 1-3/8													*		
	1.500 1-1/2							*	*	*	*	*	*	*		
	1.625 1-5/8													*		
	1.750 1-3/4							*	*	*	*	*	*	*		
1.875 1-7/8													*			
2.000 2							*	*	*	*	*	*	*	*		
2.250 2-1/4										*	*	*	*	*	*	
2.500 2-1/2										*	*	*	*	*	*	
2.750 2-3/4										*	*	*	*	*	*	
3.000 3										*	*	*	*	*	*	
3.250 3-1/4											*	*	*	*	*	
3.500 3-1/2												*	*	*	*	
3.750 3-3/4													*	*	*	
4.000 4														*	*	

Interchangeable Inch and mm Pins	
Inch Diameter	mm Diameter
.078 5/64	2.0
.156 5/32	4.0
.312 5/16	8.0
.625 5/8	16.0

Available in high carbon and stainless steels Only available in alloy steel

* Generally stocked size

¹ Pin must fall through a hole gauge in length equal to the next one-inch increment over the pin length with a hole equal to the maximum specified pin diameter plus the straightness tolerance by its own weight.

Special sizes, duties, materials and finishes, including oil-free pins, are available upon request.



LIGHT DUTY COILED PINS – INCH ASME B18.8.2

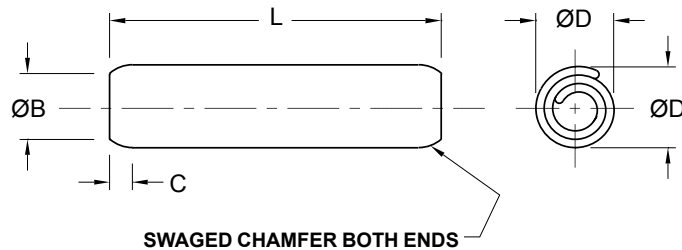

NOMINAL DIAMETER		.062	.078	.094	.109	.125	.156	.187	.219	.250	.312
		1/16	5/64	3/32	7/64	1/8	5/32	3/16	7/32	1/4	5/16
DIAMETER ØD	MAX.	.073	.089	.106	.121	.139	.172	.207	.240	.273	.339
	MIN.	.067	.083	.099	.114	.131	.163	.196	.228	.260	.324
CHAMFER	B DIA. MAX.	.059	.075	.091	.106	.121	.152	.182	.214	.243	.304
	C LENGTH REF.	.028	.032	.038	.038	.044	.048	.055	.065	.065	.080
RECOMMENDED HOLE SIZE	MAX.	.065	.081	.097	.112	.129	.160	.192	.224	.256	.319
	MIN.	.062	.078	.094	.109	.125	.156	.187	.219	.250	.312

Note: All dimensions apply prior to plating.

MINIMUM DOUBLE SHEAR STRENGTH LBS.

NOMINAL DIAMETER		.062	.078	.094	.109	.125	.156	.187	.219	.250	.312
		1/16	5/64	3/32	7/64	1/8	5/32	3/16	7/32	1/4	5/16
CARBON CHROME STAINLESS		205	325	475	650	825	1,300	1,900	2,600	3,300	5,200
NICKEL STAINLESS		160	250	360	500	650	1,000	1,450	2,000	2,600	4,000

Note: Shear tests performed in accordance with ASME B18.8.2.

STANDARD LENGTHS

NOMINAL DIAMETER		.062	.078	.094	.109	.125	.156	.187	.219	.250	.312
		1/16	5/64	3/32	7/64	1/8	5/32	3/16	7/32	1/4	5/16
LENGTHS	.250	1/4									
	.312	5/16									
	.375	3/8									
	.437	7/16									
	.500	1/2									
	.562	9/16									
	.625	5/8									
	.687	11/16									
	.750	3/4									
	.812	13/16									
	.875	7/8									
	.937	15/16									
	1.000	1									
	1.125	1-1/8									
	1.250	1-1/4									
	1.375	1-3/8									
	1.500	1-1/2									
	1.625	1-5/8									
	1.750	1-3/4									
	1.875	1-7/8									
2.000	2										
2.250	2-1/4										
2.500	2-1/2										
2.750	2-3/4										
3.000	3										
3.250	3-1/4										
3.500	3-1/2										
3.750	3-3/4										

Interchangeable Inch and mm Pins

Inch Diameter	mm Diameter
.078 5/64	2.0
.156 5/32	4.0
.312 5/16	8.0

Nominal Pin Length	Length Tolerance
Nominal Pin Size	ø1/16 - 1/4
L ≤ 2.000	± .010
2.000 < L ≤ 3.000	± .015
3.000 < L	± .025

Nominal Pin Length	Pin Straightness Tolerance ¹	Gage Length ±0.005
L ≤ 1.000	.007	1.000
1.000 < L ≤ 2.000	.010	2.000
2.000 < L	.013	3.000

Only available in stainless steel
 Available in high carbon and stainless steels

¹ Pin must fall through a hole gauge in length equal to the next one-inch increment over the pin length with a hole equal to the maximum specified pin diameter plus the straightness tolerance by its own weight.

Special sizes, duties, materials and finishes, including oil-free pins, are available upon request.

Technical Centres

Europe **SPIROL United Kingdom**
17 Princewood Road
Corby, Northants
NN17 4ET United Kingdom
Tel: +44 (0) 1536 444800
Fax: +44 (0) 1536 203415

SPIROL France
Cité de l'Automobile ZAC Croix Blandin
18 Rue Léna Bernstein
51100 Reims, France
Tel: +33 (0) 3 26 36 31 42
Fax: +33 (0) 3 26 09 19 76

SPIROL Germany
Ottostr. 4
80333 Munich, Germany
Tel: +49 (0) 89 4 111 905 71
Fax: +49 (0) 89 4 111 905 72

SPIROL Spain
Plantes 3 i 4
Gran Via de Carles III, 84
08028, Barcelona, Spain
Tel/Fax: +34 932 71 64 28

SPIROL Czech Republic
Evropská 2588 / 33a
160 00 Prague 6-Dejvice
Czech Republic
Tel: +420 226 218 935

SPIROL Poland
ul. Solec 38 lok. 10
00-394, Warsaw, Poland
Tel. +48 510 039 345

Americas **SPIROL International Corporation**
30 Rock Avenue
Danielson, Connecticut 06239 U.S.A.
Tel. +1 860 774 8571
Fax. +1 860 774 2048

SPIROL Shim Division
321 Remington Road
Stow, Ohio 44224 U.S.A.
Tel. +1 330 920 3655
Fax. +1 330 920 3659

SPIROL Canada
3103 St. Etienne Boulevard
Windsor, Ontario N8W 5B1 Canada
Tel. +1 519 974 3334
Fax. +1 519 974 6550

SPIROL Mexico
Avenida Avante #250
Parque Industrial Avante Apodaca
Apodaca, N.L. 66607 Mexico
Tel. +52 81 8385 4390
Fax. +52 81 8385 4391

SPIROL Brazil
Rua Mafalda Barnabé Soliane, 134
Comercial Vitória Martini,
Distrito Industrial,
CEP 13347-610, Indaiatuba, SP, Brazil
Tel. +55 19 3936 2701
Fax. +55 19 3936 7121

Asia Pacific **SPIROL Asia Headquarters**
1st Floor, Building 22, Plot D9, District D
No. 122 HeDan Road
Wai Gao Qiao Free Trade Zone
Shanghai, China 200131
Tel: +86 (0) 21 5046-1451
Fax: +86 (0) 21 5046-1540

SPIROL Korea
16th Floor, 396 Seocho-daero,
Seocho-gu, Seoul, 06619, South Korea
Tel: +82 (0) 10 9429 1451

e-mail: info-uk@spirol.com

SPIROL.co.uk



Coiled Spring Pins



Slotted Spring Pins



Solid Pins



Alignment Dowels /
Bushings

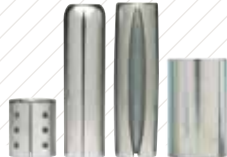

Spacers & Rolled
Tubular Components

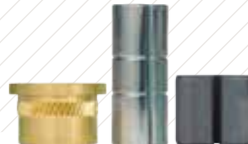

Compression
Limiters



Threaded Inserts
for Plastics



Railroad Nuts



Disc Springs



Precision Shims &
Thin Metal Stampings

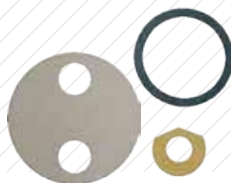

Precision Washers



Parts Feeding
Technology



Pin Installation
Technology



Insert Installation
Technology



Compression Limiter
Installation Technology

Please refer to www.SPIROL.co.uk for current specifications and standard product offerings.

SPIROL offers complimentary Application Engineering support! We will assist on new designs as well as help resolve issues, and recommend cost savings on existing designs. Let us help by visiting **Application Engineering Services** on SPIROL.co.uk.